

# School maps

---

January 2026

- |          |   |           |   |
|----------|---|-----------|---|
| <b>1</b> | Greater London                              | <b>5</b>  | Sussex Place, North Building and Taunton Centre |
| <b>2</b> | London Business School and surrounding area | <b>6</b>  | Sussex Place                                    |
| <b>3</b> | Campus overview                             | <b>12</b> | North Building                                  |
| <b>4</b> | Getting to the School                       | <b>18</b> | Sammy Ofer Centre                               |

# Index

## Lecture Theatres

### Sammy Ofer Centre

Building	Floor	Room Space Known As	Page
East Wing	0	SO.E.14 Lecture Theatre LT14	19
	0	SO.E.15 Graduating Class Gift Lecture Theatre LT15	19
	1	SO.E.16 Lecture Theatre LT16	20
	1	SO.E.17 Redeemer Foundation Lecture Theatre/Kwok Lecture Theatre LT17	20
	2	SO.E.18 David El Pyott Foundation Lecture Theatre LT18	21
	2	SO.E.19 David El Pyott Foundation Lecture Theatre LT19	21

### Sussex Place

Building	Floor	Room Space Known As	Page
E Wing	0	PL.E.07 Lecture Theatre LT7	7
	1	PL.E.08 Transmed Lecture Theatre	8
Plowden	1	PL.P.12 Pathiraja Fryland Møller Lecture Theatre LT12	8
Ratcliffe	-1	RB.R.01 Lecture Theatre LT1	6
	-1	RB.R.02 Lecture Theatre LT2	6
	-1	RB.R.03 Lecture Theatre LT3	6
	-1	RB.R.04 Lecture Theatre LT4	6
	-1	RB.R.05 Lecture Theatre LT5	6
	-1	RB.R.06 Lecture Theatre LT6	6
	0	RB.R.11 Lecture Theatre LT11	7
	1	RB.R.09 Lecture Theatre LT9	8
	1	RB.R.10 Lecture Theatre LT10	8
North Building	-2	NB.13 Lecture Theatre LT13	16

## Group Rooms & Flat Floor Spaces

### Sammy Ofer Centre

Building	Floor	Room Space Known As	Page
East Wing	0	SO.E0.04-08 Group Rooms	19
	1	SO.E1.01-02, 05-08 Group Rooms	20
	1	SO.E1.03 Vina Mak MSc19(1985) & Vincent Mak Room Flat Floor	20
	1	SO.E1.04 Flat Floor	20
	2	SO.E2.01-03 Group Rooms	21
	3	SO.E3.01-04, 07-14 Group Rooms	23
West Wing	1	SO.W1.05 Group Room	20
	2B	SO.W2.07-11 Group Rooms	22
	3	SO.W3.04-10 Group Rooms	23

### Sussex Place

Building	Floor	Room Space Known As	Page
A Wing	0	RB.A0.01-16 Group Rooms	7
C Wing	0	PL.C0.01-02 Group Rooms	7
D Wing	0	PL.D0.01-06 Group Rooms	7
E Wing	-1	PL.E-1.01-03 Group Rooms	6
	0	PL.E0.01-06 Group Rooms	7
	1	PL.E1.01-06 Group Rooms	8
	2	PL.E2.01-05 Group Rooms	9
	2	PL.E2.06 Flat Floor	9
	3	PL.E3.02-06 Group Rooms	10
	3	PL.E3.07 Flat Floor	10
	3	PL.E3.08 Flat Floor	10
Plowden	1	PL.P1.01 Flat Floor	8
	2	PL.P2.01, 03-21 Group Rooms	9
	2	PL.P2.02 Flat Floor	9
Ratcliffe	0	RB.R0.01-08 Group Rooms	7
	1	RB.R1.01-05, 09-16 Group Rooms	8

# Index

## Sussex Place

Building	Floor	Room Space Known As	Page
North Building	-2	NB.-2.01-06 Flat Floors	12
	-1	NB.-1.01, 02, 05 & 07 Flat Floors	13
	0	NB.0.01-12 Executive Group Rooms	14
	1	NB.1.01-09 Executive Group Rooms	15
	1	NB.1.10 Council Chamber	15
	1	NB.1.12 Committee Room	15
	2	NB.2.01-06 Executive Group Rooms	16

## Collaborative Learning Classrooms

### Sussex Place

Building	Floor	Room Space Known As	Page
Plowden	-1	PL.P-1.01 Collaborative Learning Classroom 01	6
	1	PL.P1.02 Collaborative Learning Classroom 02	8

## Retail & Hospitality Spaces

### Sammy Ofer Centre

Building	Floor	Room Space Known As	Page
East Wing	0	The Café	19
West Wing	1	Student Lounge	20

### Sussex Place

Building	Floor	Room Space Known As	Page
A Wing	0	Nash Lounge	7
B Wing	0	RB.B0.01 Garden Room	7
	0	RB.B0.02 Park Restaurant Suite 1	7
	0	RB.B0.03 Park Restaurant Suite 2	7
Ratcliffe	-1	RB.R-1 Platform	6
	0	RB.R0.09 Regents Room	7
	0	RB.R0.10 Dining Room	7

## Sussex Place

Building	Floor	Room Space Known As	Page
Ratcliffe	0	RB.R0.11 Sussex Room	7
	1	RB.R1.06 Lounge	8
	1	RB.R1.07 Lounge	8
Plowden	0	Plowden Lounge	7
	1	Lounge	8
North Building	0	NB.0.18 The Bagri Hive	14
	0	Airstream	14
	1	NB.1.14 Lounge	15

## First Aid, Nursing and Reflection Rooms

### Sammy Ofer Centre

Building	Floor	Room Space Known As	Page
West Wing	1	First Aid Room	20
	4	Reflection Room The Stuhlberger Family Room	24

### Sussex Place

Building	Floor	Room Space Known As	Page
Laing House	-1	LH.-1.02 Reflection Room	6
	-1	LH.-1.04 Nursing Room	6
Plowden	0	First Aid & Nursing Room	7

## Microwaves & Kettles for Students

### Sammy Ofer Centre

Building Name	Floor	Room Space Known As	Page
West Wing	2	SO.W2.03 Print/Copy/Scan	21
	2B	SO.W2.12 Print/Copy/Scan	22

### Sussex Place

Building	Floor	Room Space Known As	Page
Laing House	0	Kitchenette	7



**London  
Business  
School**

**London Business School**

Regent's Park  
London NW1 4SA  
United Kingdom

Tel +44 (0)20 7000 7000  
Fax +44 (0)20 7000 7001

**london.edu**

## Greater London

### City Airport

(10 miles east of the School)

Take the Docklands Light Railway from the airport to Tower Hill and then take the London Underground to Baker Street.

**londoncityairport.com**

### Heathrow Airport

(13 miles west of the School)

Take the Heathrow Express train to Paddington Station and then the London Underground to Baker Street. Alternatively, take the London Underground to Baker Street.

**heathrowairport.com**

### Gatwick Airport

(25 miles south of the School)

Take the Gatwick Express train to London Victoria Station or London Bridge Station and then the London Underground to Baker Street.

**gatwickairport.com**

### Luton Airport

(25 miles north of the School)

Take a Thameslink train to West Hampstead and then the London Underground to Baker Street.

**london-luton.co.uk**

### Stansted Airport

(30 miles north east of the School)

Take the Stansted Express train to Liverpool Street Station and then the London Underground to Baker Street. Alternatively, take the A6 Airbus to Baker Street (approximately 1.5 hours).

**stanstedairport.com**

#### Useful link:

London Underground map

**<https://tfl.gov.uk/maps/track/tube>**



# London Business School and surrounding area

## Baker Street

Approximately 5 minutes' walk.

## Marylebone

Approximately 5 minutes' walk.

## Euston

Take the Northern or Victoria line to King's Cross St. Pancras. Then the Metropolitan, Circle or Hammersmith and City line to Baker Street.

## Paddington

Take the Bakerloo, Circle or Hammersmith and City line to Baker Street.

## King's Cross St. Pancras

Take the Metropolitan, Circle or Hammersmith and City line to Baker Street.

## Charing Cross

Take the Bakerloo line to Baker Street.

## Waterloo

Take the Jubilee or Bakerloo line to Baker Street.

**London  
Business  
School**

### London Business School

Regent's Park  
London NW1 4SA  
United Kingdom

Tel +44 (0)20 7000 7000

Fax +44 (0)20 7000 7001

[london.edu](http://london.edu)

### Useful link:

London Underground map

<https://tfl.gov.uk/maps/track/tube>

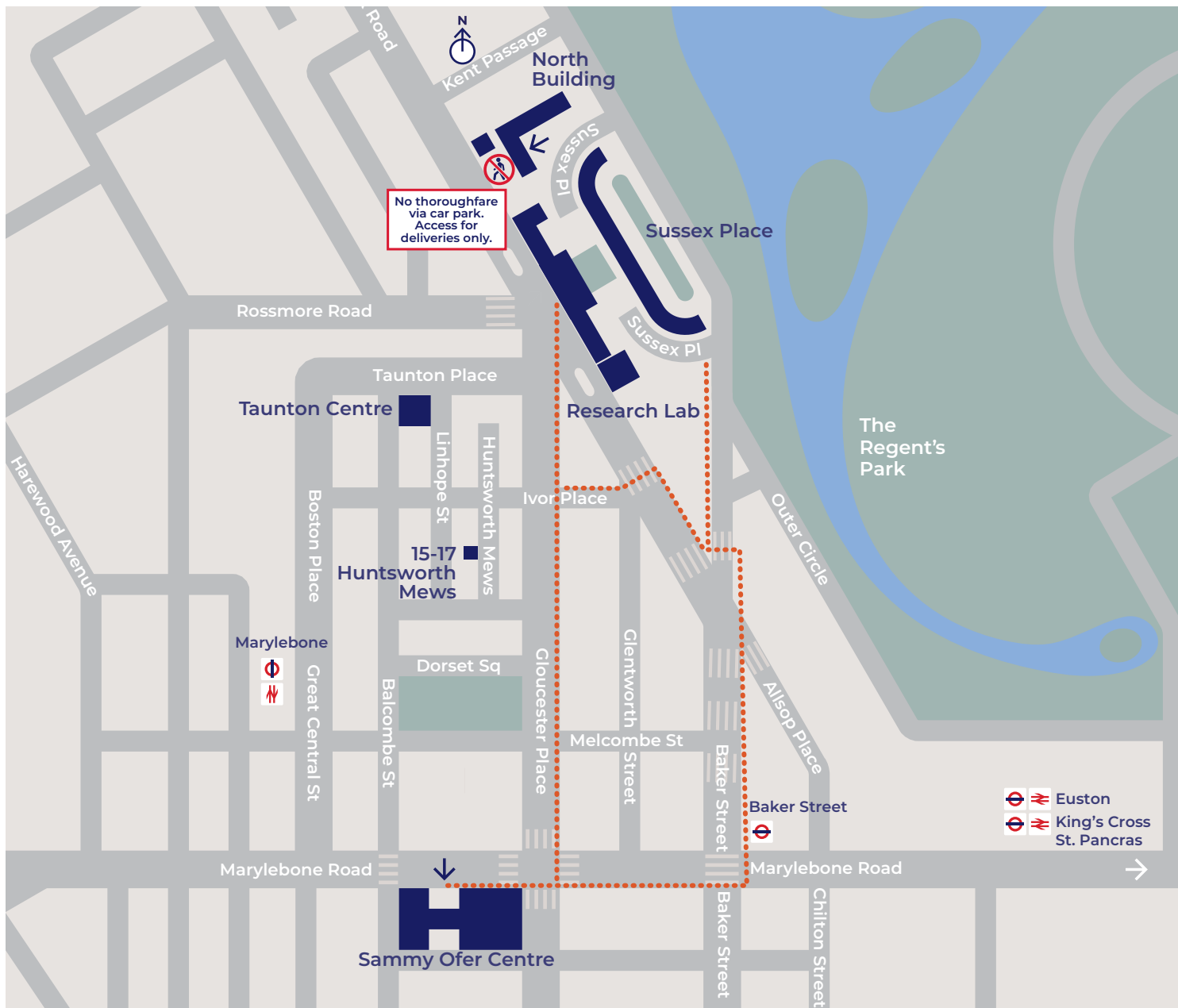

## Campus overview walking routes

Postcodes for finding routes  
or online directions  
not for mailing

**Sussex Place –  
Plowden, Ratcliffe and North Buildings:**  
NW1 4SA

**Research Lab**  
26 Park Road, NW1 4SH

**Taunton:**  
NW1 6HB

**Huntsworth Mews:**  
NW1 6DD

**Sammy Ofer Centre:**  
NW1 5PT

### KEY

Walking route .....>

London  
Business  
School

**London Business School**  
Regent's Park  
London NW1 4SA  
United Kingdom

Tel +44 (0)20 7000 7000  
Fax +44 (0)20 7000 7001  
**london.edu**

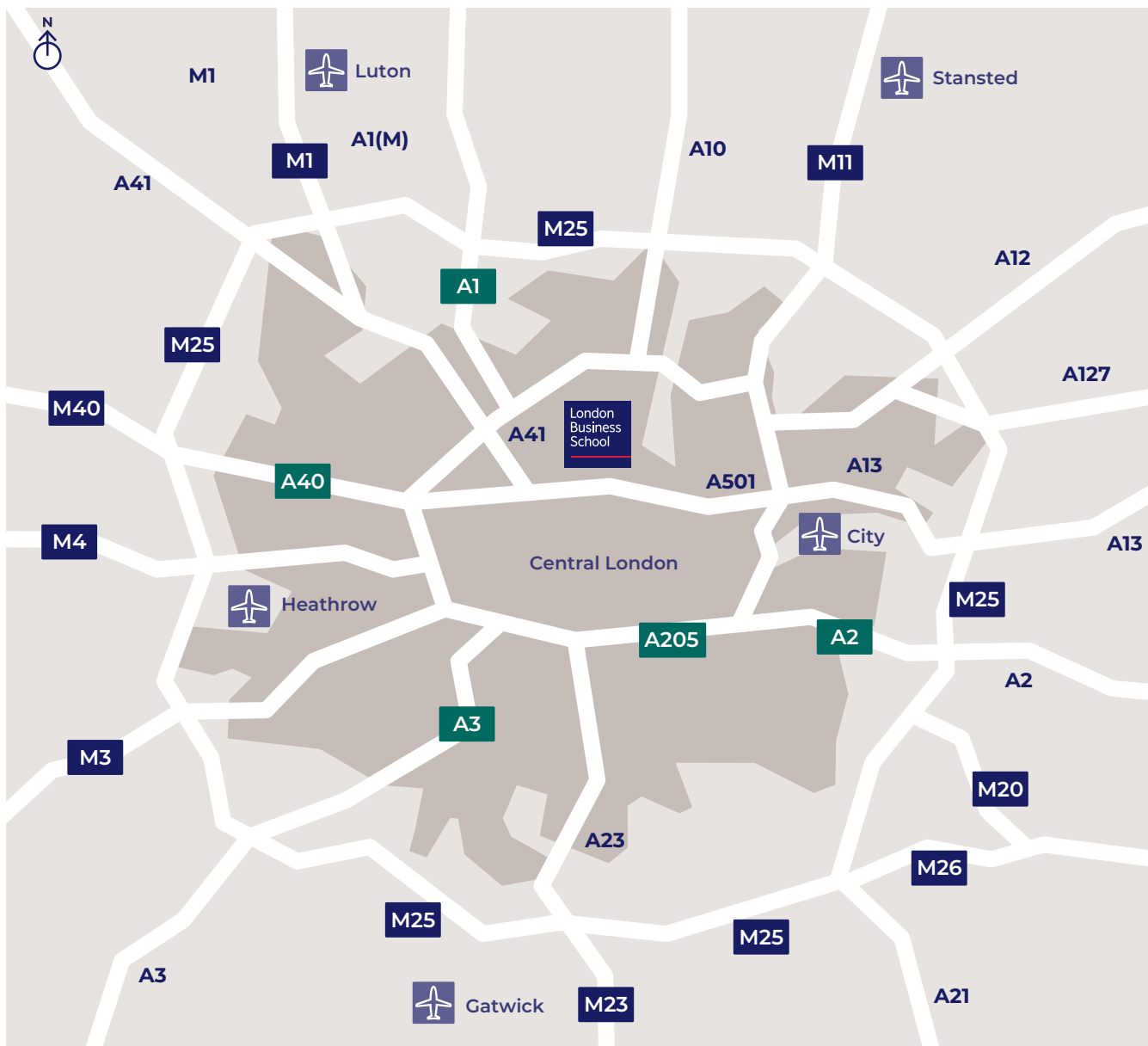

## Getting to the School

### Baker Street

Approximately 5 minutes' walk.

### Marylebone

Approximately 5 minutes' walk.

### Euston

Take the Northern or Victoria line to King's Cross St. Pancras. Then the Metropolitan, Circle or Hammersmith and City line to Baker Street.

### Paddington

Take the Bakerloo, Circle or Hammersmith and City line to Baker Street.

### King's Cross St. Pancras

Take the Metropolitan, Circle or Hammersmith and City line to Baker Street.

### Charing Cross

Take the Bakerloo line to Baker Street.

### Waterloo

Take the Jubilee or Bakerloo line to Baker Street.

London  
Business  
School

#### London Business School

Regent's Park  
London NW1 4SA  
United Kingdom

Tel +44 (0)20 7000 7000  
Fax +44 (0)20 7000 7001

[london.edu](http://london.edu)

#### Useful link:

London Underground map

<https://tfl.gov.uk/maps/track/tube>

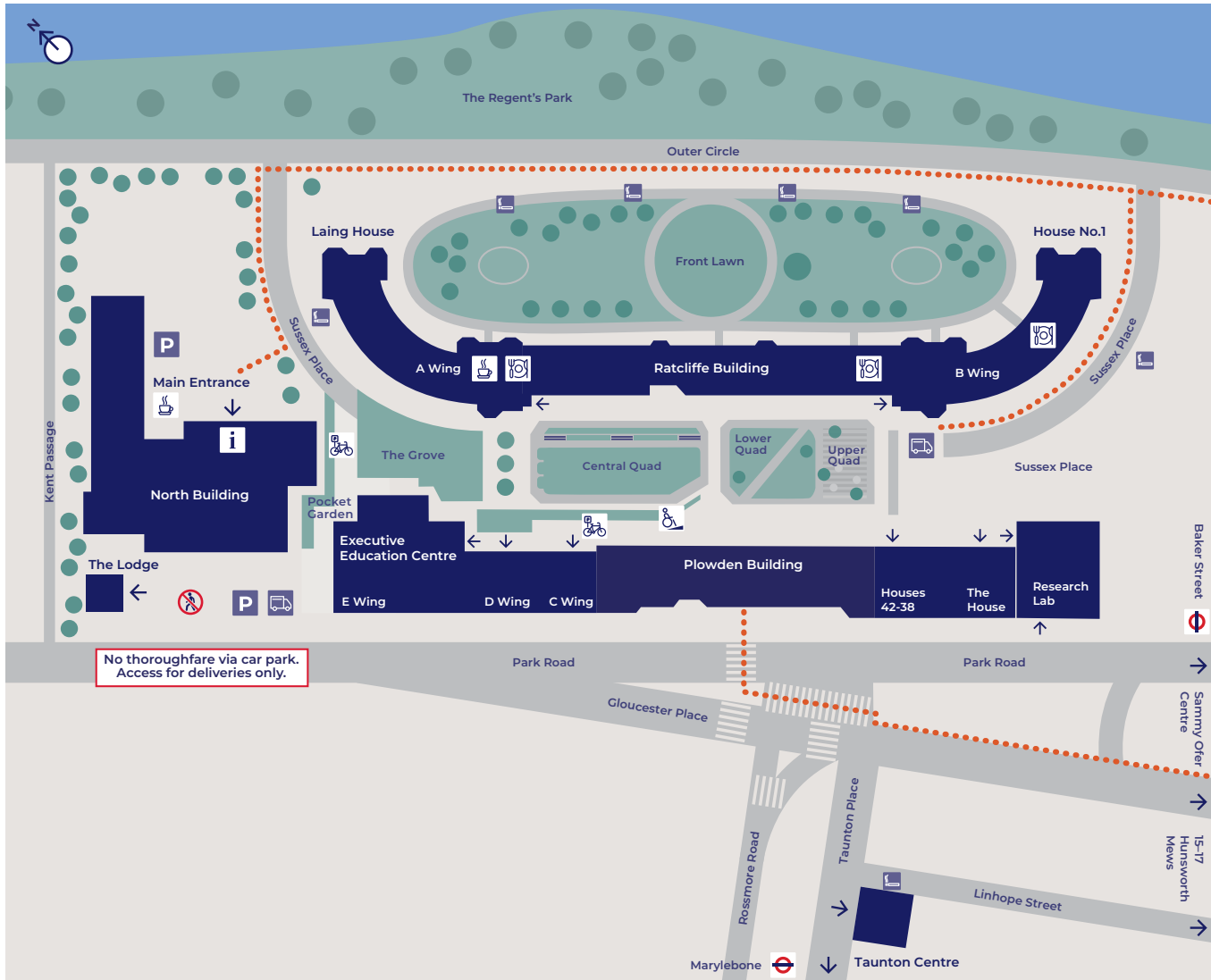

## Sussex Place, North Building and Taunton Centre

### RESEARCH LAB

26 Park Road

### THE HOUSE

Incubator Programme

### HOUSES 42-38

Research Centres  
Institute of Entrepreneurship and Private Capital  
Wheeler Institute for Business and Development  
People Team

### PLOWDEN BUILDING

PL.P-1.01 Collaborative Learning Classroom 01  
Plowden Interchange  
Plowden Lounge  
PL.P.12 Pathiraja Fryland  
Møller Lecture Theatre LT12  
PL.P1.01 Flat Floor Lounge  
PL.P1.02 Collaborative Learning Classroom 02  
PL.P2.02 Flat Floor  
Student Wellbeing Services Lounge & Office  
PL.P3.01 Quiet Study  
Career Centre  
Executive Education Centre  
PL.E-1 Lounge  
PL.E.07 Lecture Theatre LT7  
PL.E.08 Transmed Lecture Theatre

PL.2.06 Flat Floor  
PL.E2 Lounge  
PL.E3.07 Flat Floor  
C & D Wing

### NORTH BUILDING

Main Reception  
The Airstream  
The Bagri Hive  
Alumni Lounge  
NB.13 Lecture Theatre LT13  
Committee Room  
Council Chamber  
Nuffield Hall  
The Andrews Centre  
Advancement office  
Brand and Marketing office  
Executive Education office  
The Lodge  
Post Room

### LAING HOUSE

LH.-1.02 Reflection Room  
LH.-1.04 Nursing Room

### A WING

Nash Lounge

### RATCLIFFE BUILDING

RB.R.01-06 Lecture Theatres LT1-6  
RB.R.11 Lecture Theatre LT11  
RB.R.09-10 Lecture Theatres LT9-LT10  
RB.0.19 Regents Room  
RB.0.10 Dining Room  
RB.0.11 Sussex Room

### B WING

RB.0.01 Garden Room  
RB.B0.01-02 Park Restaurants Suites 1 & 2

### TAUNTON CENTRE

Fitness and Wellbeing Centre

### KEY

North Building	NB	Cafe	Cycle bay	Female shower
Sammy Ofer Centre	SO	Lifts	Male WC	Accessible shower
Deliveries		Accessible lifts	Female WC	Gender neutral shower
Parking	P	Disabled ramp access	Accessible WC	Walking route
Reception	i	Restaurant	Gender neutral WC	Microwave for students
Reflection Room		Smoking locations	Male shower	Hot water point for students

London  
Business  
School

London Business School

Regent's Park  
London NW1 4SA  
United Kingdom

[london.edu](http://london.edu)



# Sussex Place

Laing House, A Wing, Ratcliffe, B Wing, Houses 38-42, Plowden, C, D & E Wings

FLOOR -1

Nursing Room  
Reflection Room  
Rooms LH.-1.01-04



Maintenance area

RB.R.01 Lecture Theatre LT1  
RB.R.02 Lecture Theatre LT2

RB.R.03 Lecture Theatre LT3  
RB.R.04 Lecture Theatre LT4  
RB.R.05 Lecture Theatre LT5  
RB.R.06 Lecture Theatre LT6

Catering offices  
and kitchens

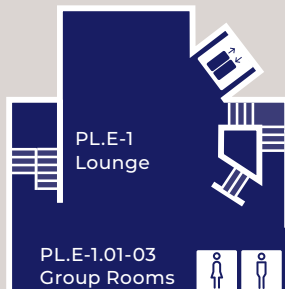

PL.E-1  
Lounge

PL.E-1.01-03  
Group Rooms



PL.C-1.01  
Student  
Association  
office

PL.P-1.01 Collaborative  
Learning Classroom 01

House 42 House 40 House 38 The House



Rooms H36.-1.01

Refer to page 5 for key legend

London  
Business  
School

London Business School

Regent's Park  
London NW1 4SA  
United Kingdom

Tel +44 (0)20 7000 7000

Fax +44 (0)20 7000 7001

[london.edu](http://london.edu)

# Sussex Place

Laing House, A Wing, Ratcliffe, B Wing, Research Lab, Houses 38-42, Plowden, C, D & E Wings

## GROUND FLOOR

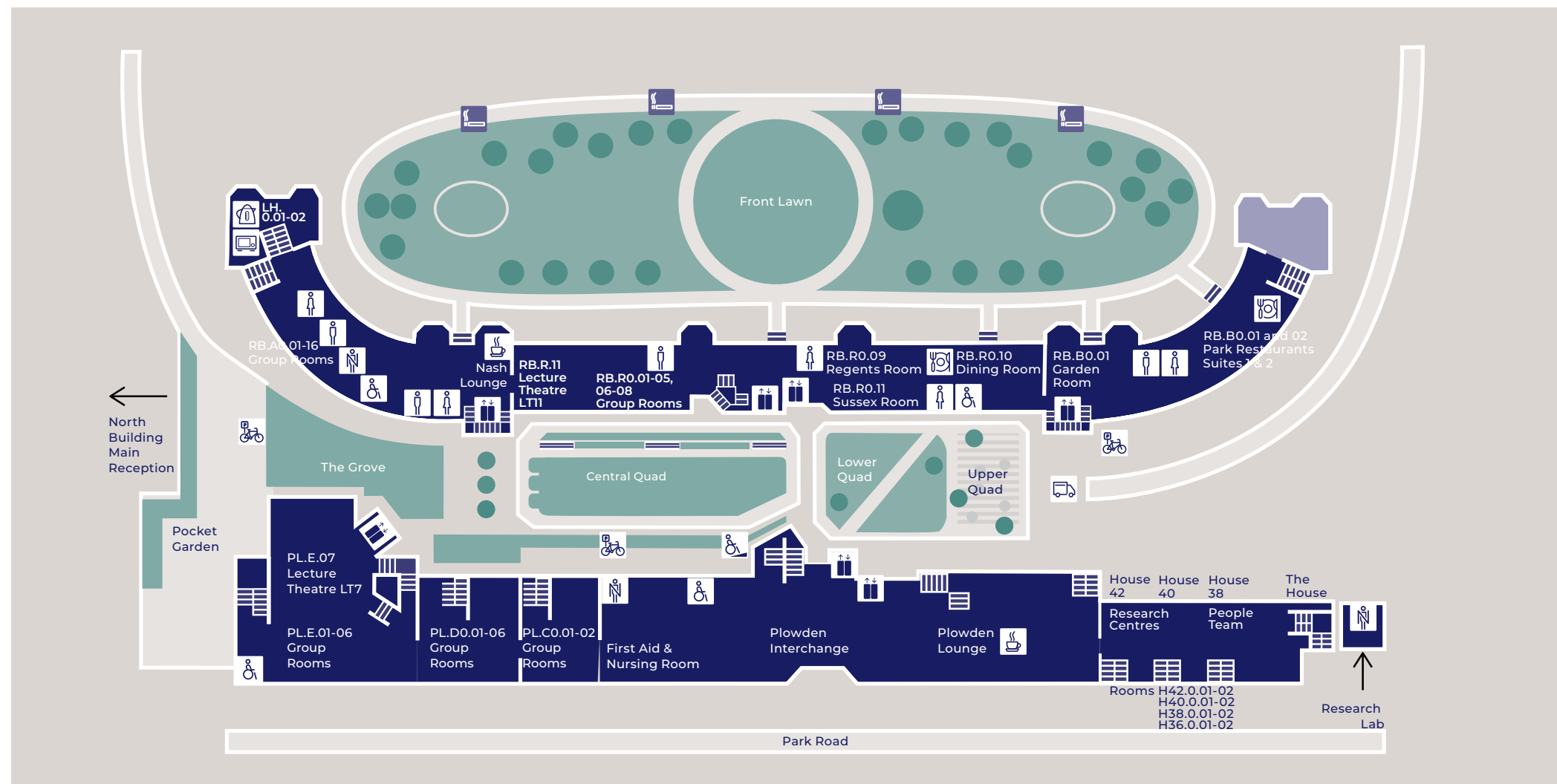

Refer to page 5 for key legend

London  
Business  
School

**London Business School**  
Regent's Park  
London NW1 4SA  
United Kingdom

Tel +44 (0)20 7000 7000  
Fax +44 (0)20 7000 7001  
[london.edu](http://london.edu)

# Sussex Place

Laing House, A Wing, Ratcliffe, B Wing, Houses 38-42, Plowden, C, D & E Wings

## FIRST FLOOR

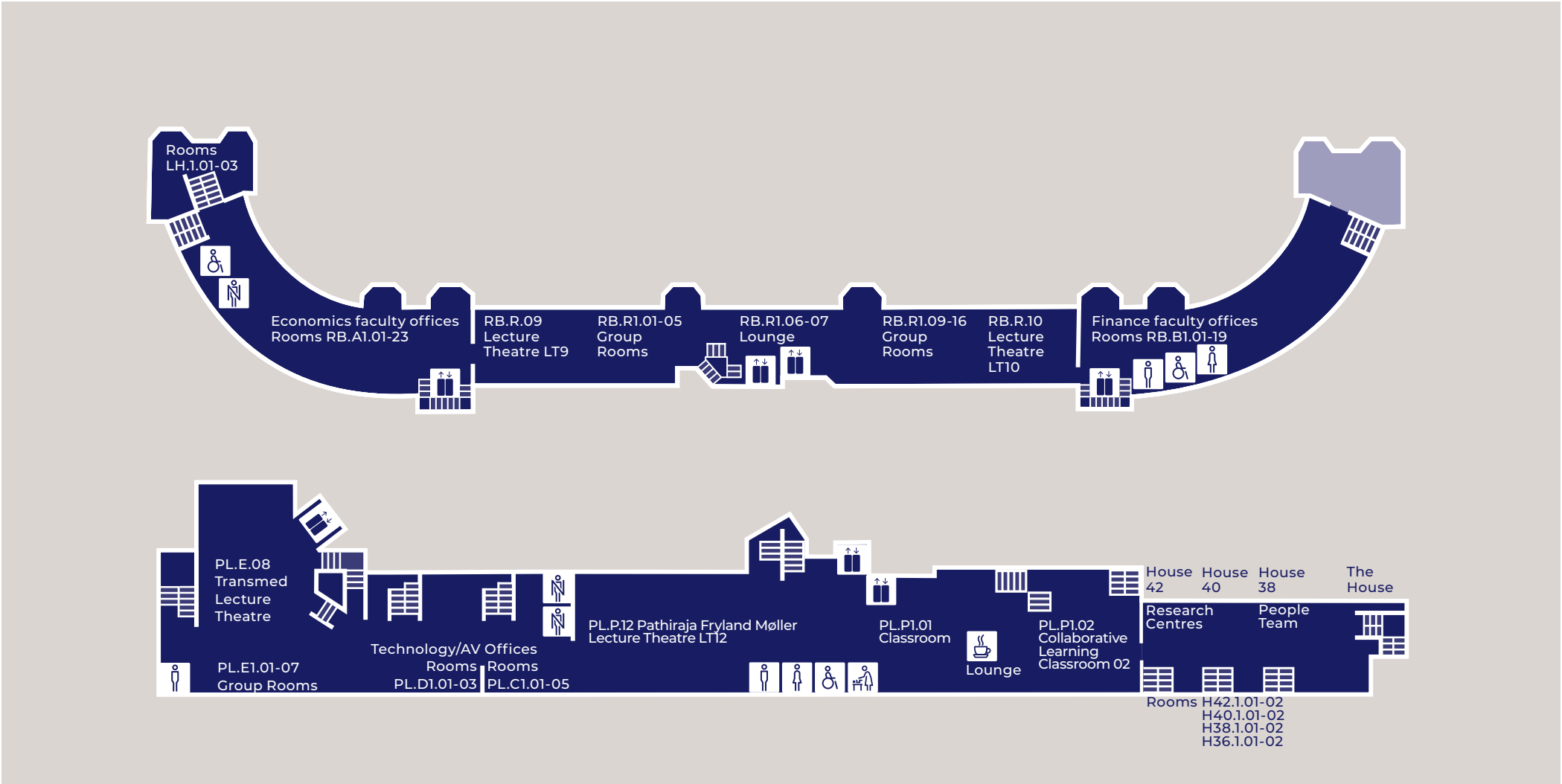

Refer to page 5 for key legend



**London Business School**  
Regent's Park  
London NW1 4SA  
United Kingdom

Tel +44 (0)20 7000 7000  
Fax +44 (0)20 7000 7001  
[london.edu](http://london.edu)

# Sussex Place

Laing House, A Wing, Ratcliffe, B Wing, Houses 38-42, Plowden, C, D & E Wings

## SECOND FLOOR

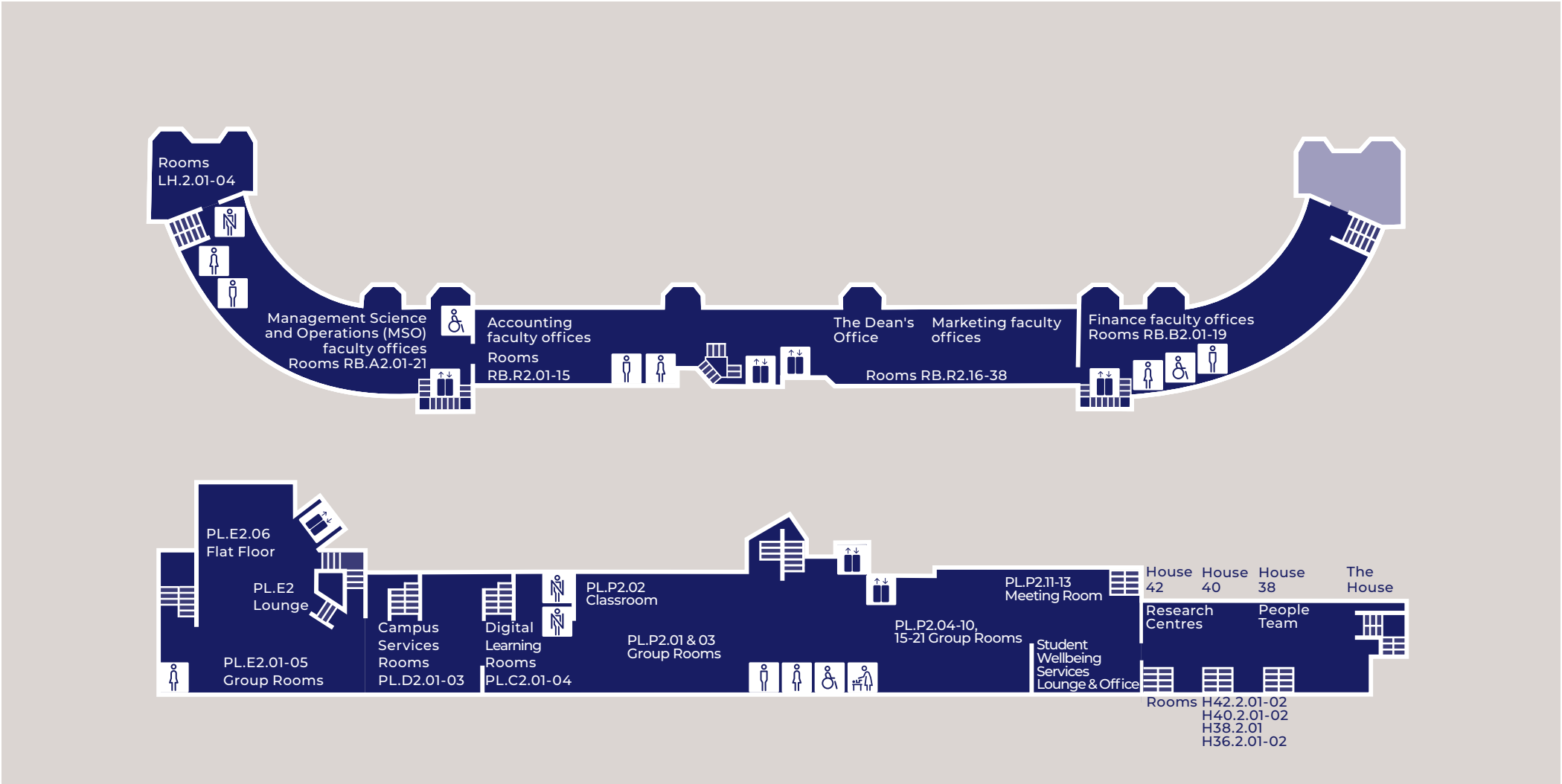

Refer to page 5 for key legend



**London Business School**  
Regent's Park  
London NW1 4SA  
United Kingdom

Tel +44 (0)20 7000 7000  
Fax +44 (0)20 7000 7001  
[london.edu](http://london.edu)

# Sussex Place

Laing House, A Wing, Ratcliffe, B Wing, Houses 38-42, Plowden, C, D & E Wings

THIRD FLOOR

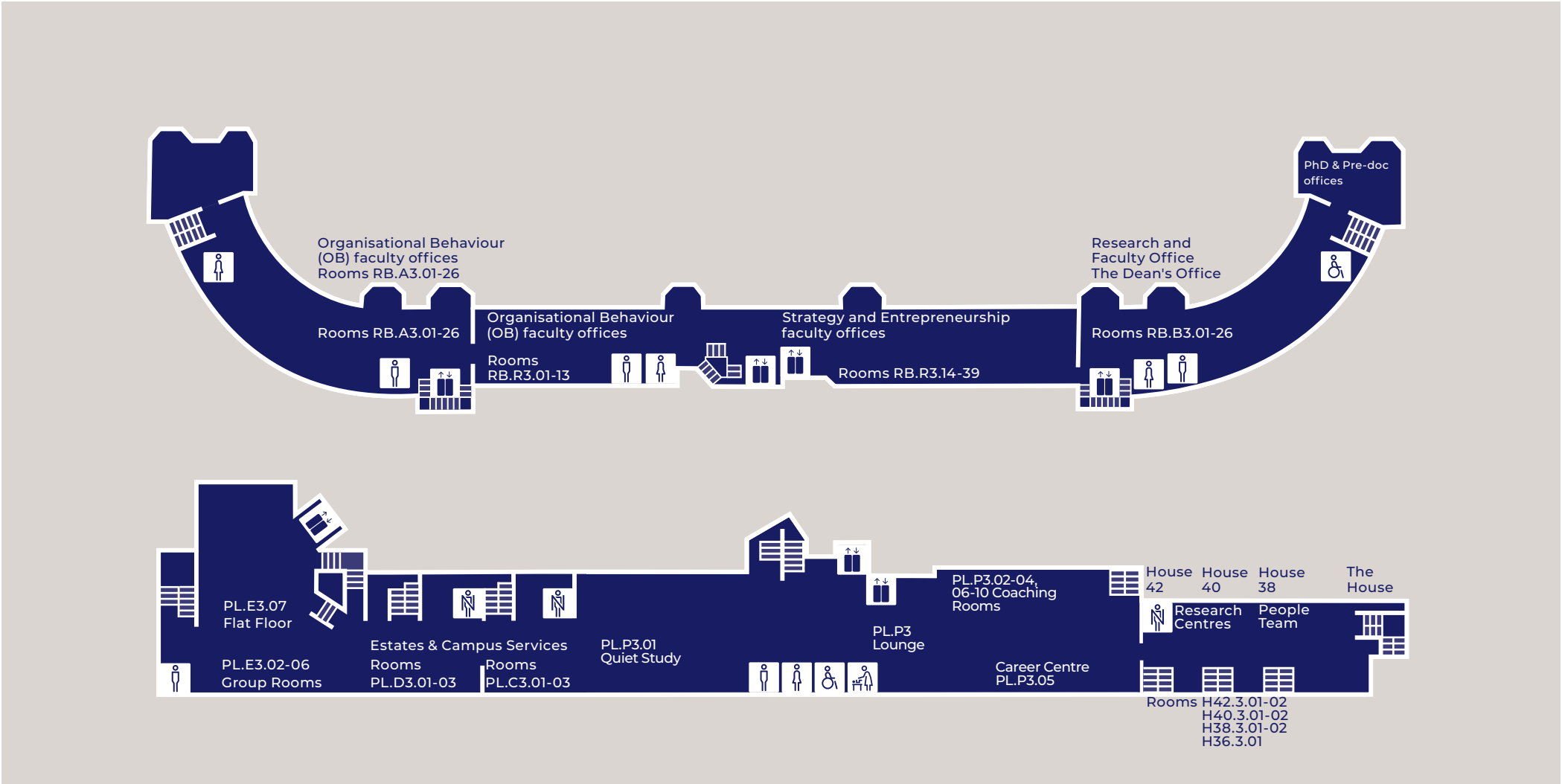

Refer to page 5 for key legend

Sussex Place  
Ratcliffe  
FOURTH FLOOR

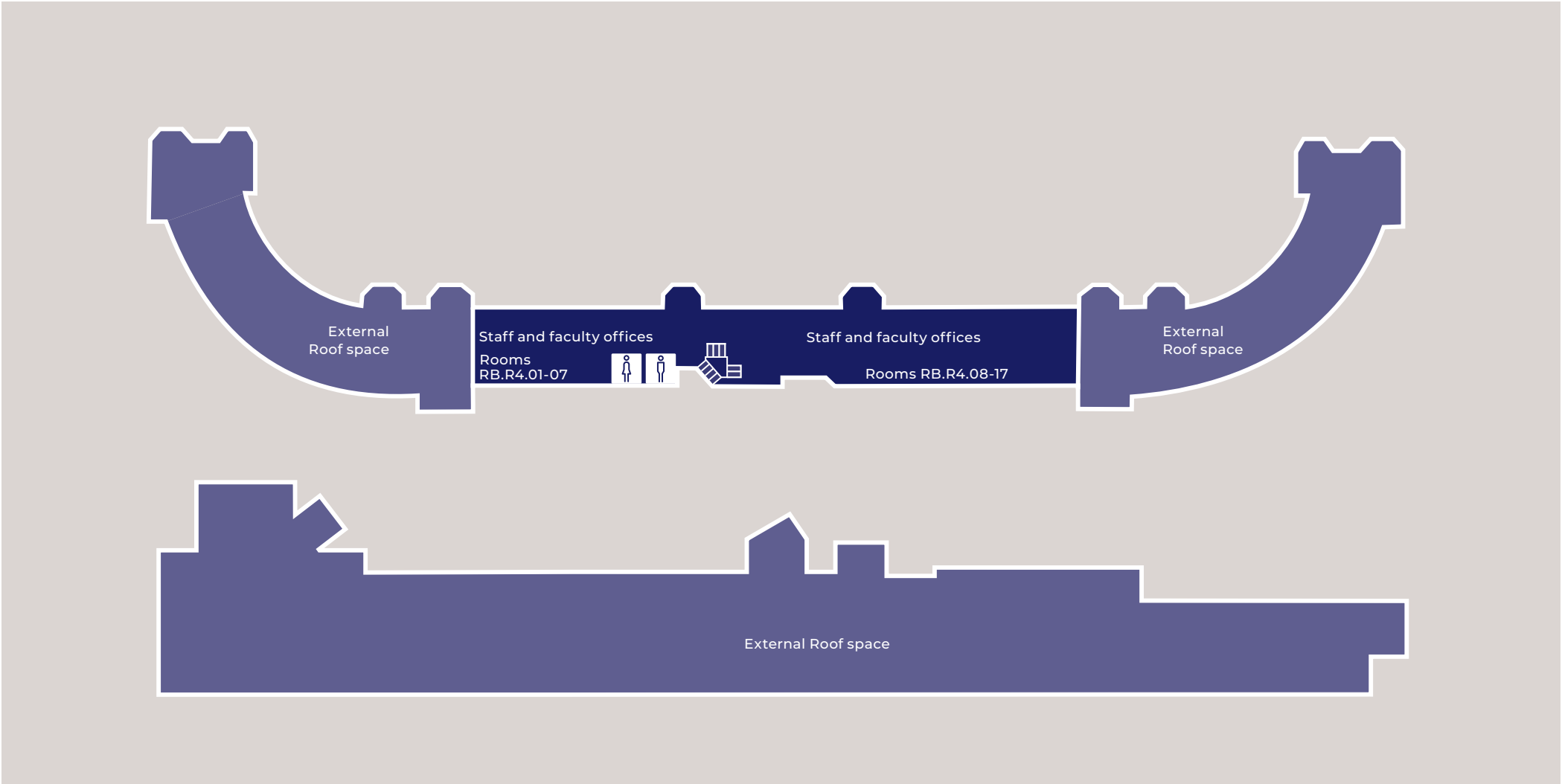

Refer to page 5 for key legend



**London Business School**  
Regent's Park  
London NW1 4SA  
United Kingdom

Tel +44 (0)20 7000 7000  
Fax +44 (0)20 7000 7001  
**[london.edu](http://london.edu)**

Sussex Place  
North Building  
FLOOR -2

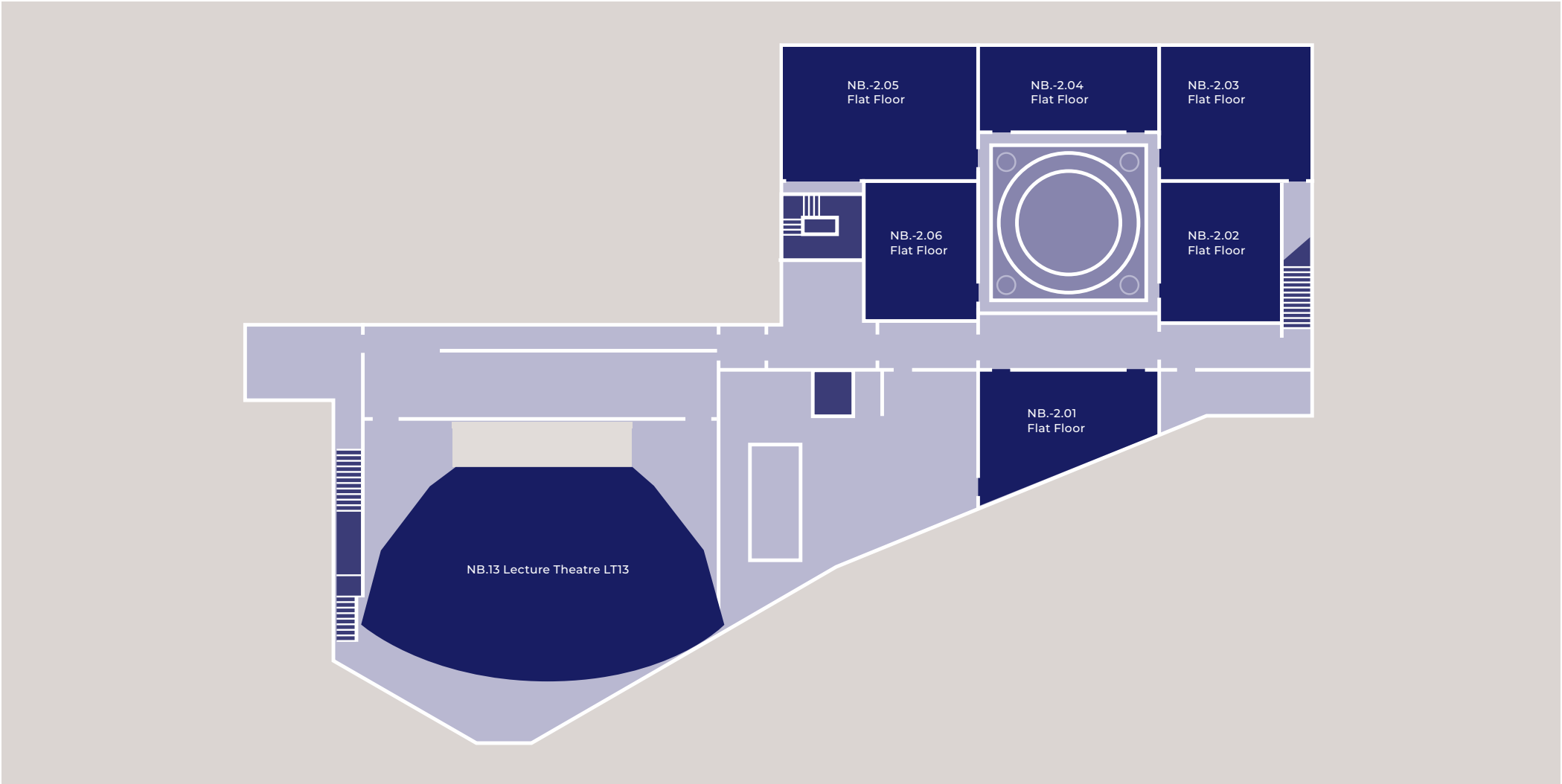

Refer to page 5 for key legend



**London Business School**  
Regent's Park  
London NW1 4SA  
United Kingdom

Tel +44 (0)20 7000 7000  
Fax +44 (0)20 7000 7001  
**[london.edu](http://london.edu)**

Sussex Place  
North Building  
FLOOR -1

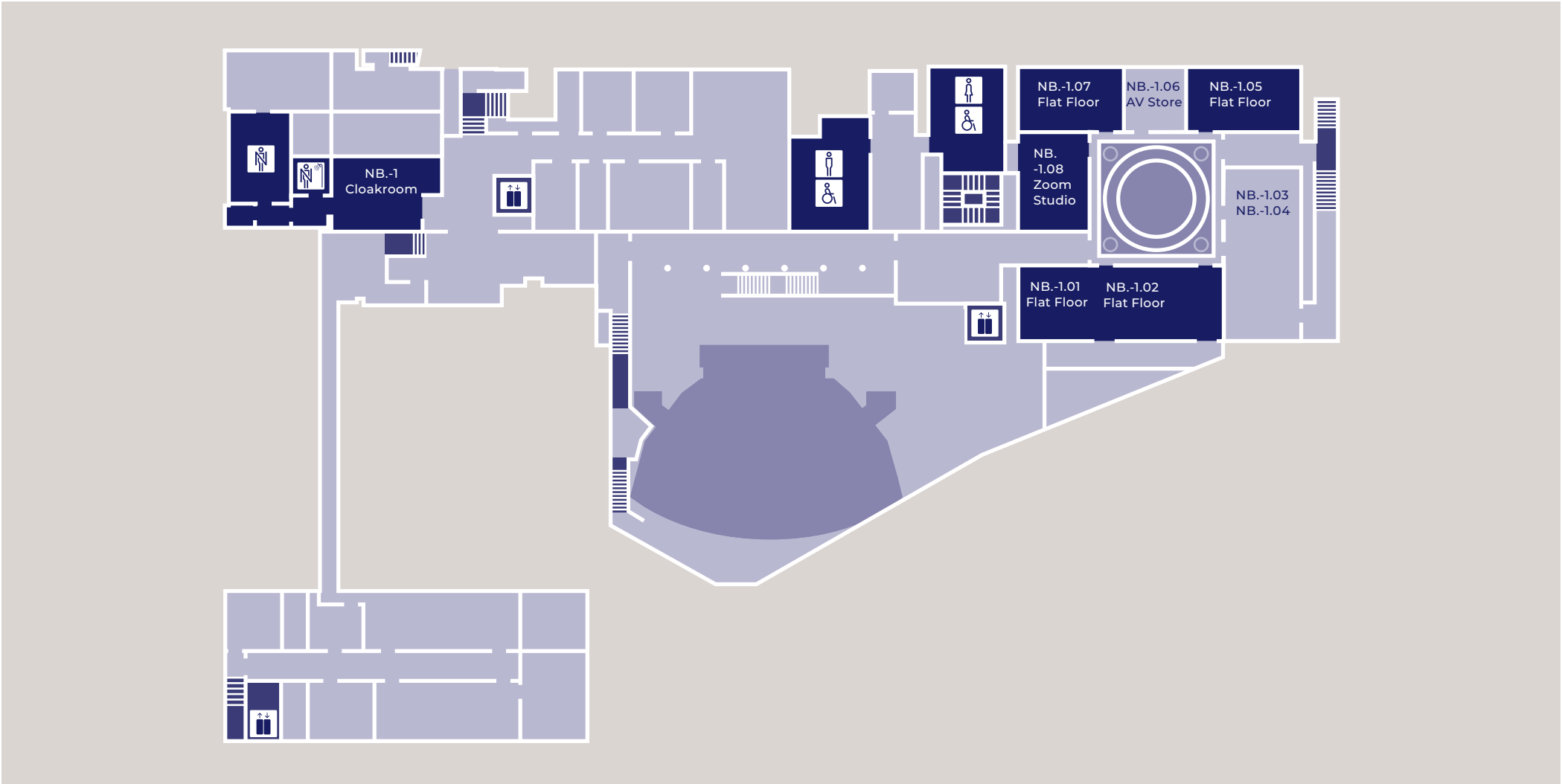

Refer to page 5 for key legend



**London Business School**  
Regent's Park  
London NW1 4SA  
United Kingdom

Tel +44 (0)20 7000 7000  
Fax +44 (0)20 7000 7001  
**[london.edu](http://london.edu)**



Sussex Place  
North Building  
GROUND FLOOR

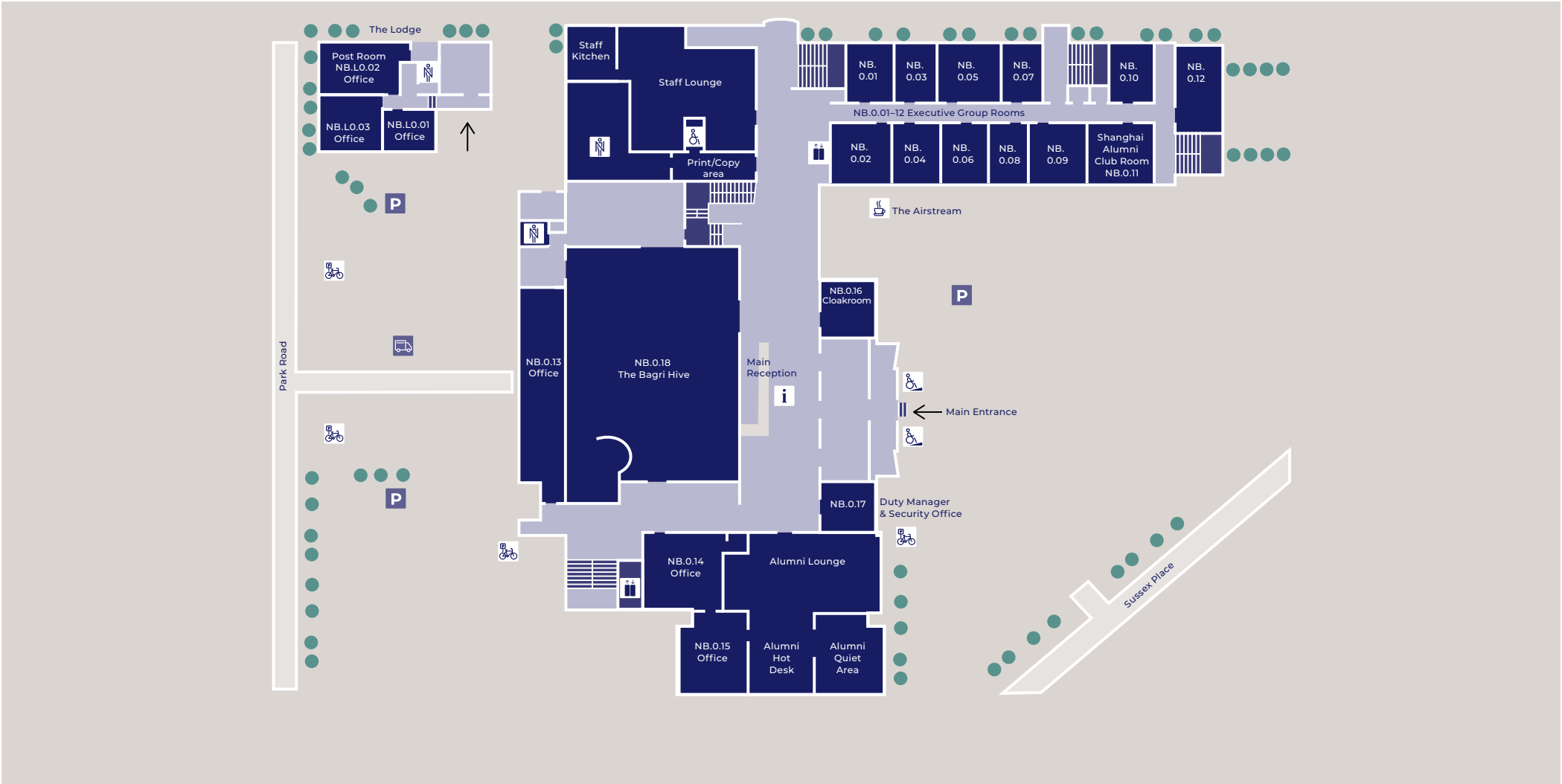

Refer to page 5 for key legend

Sussex Place  
North Building  
FIRST FLOOR



Refer to page 5 for key legend

Sussex Place  
North Building  
SECOND FLOOR

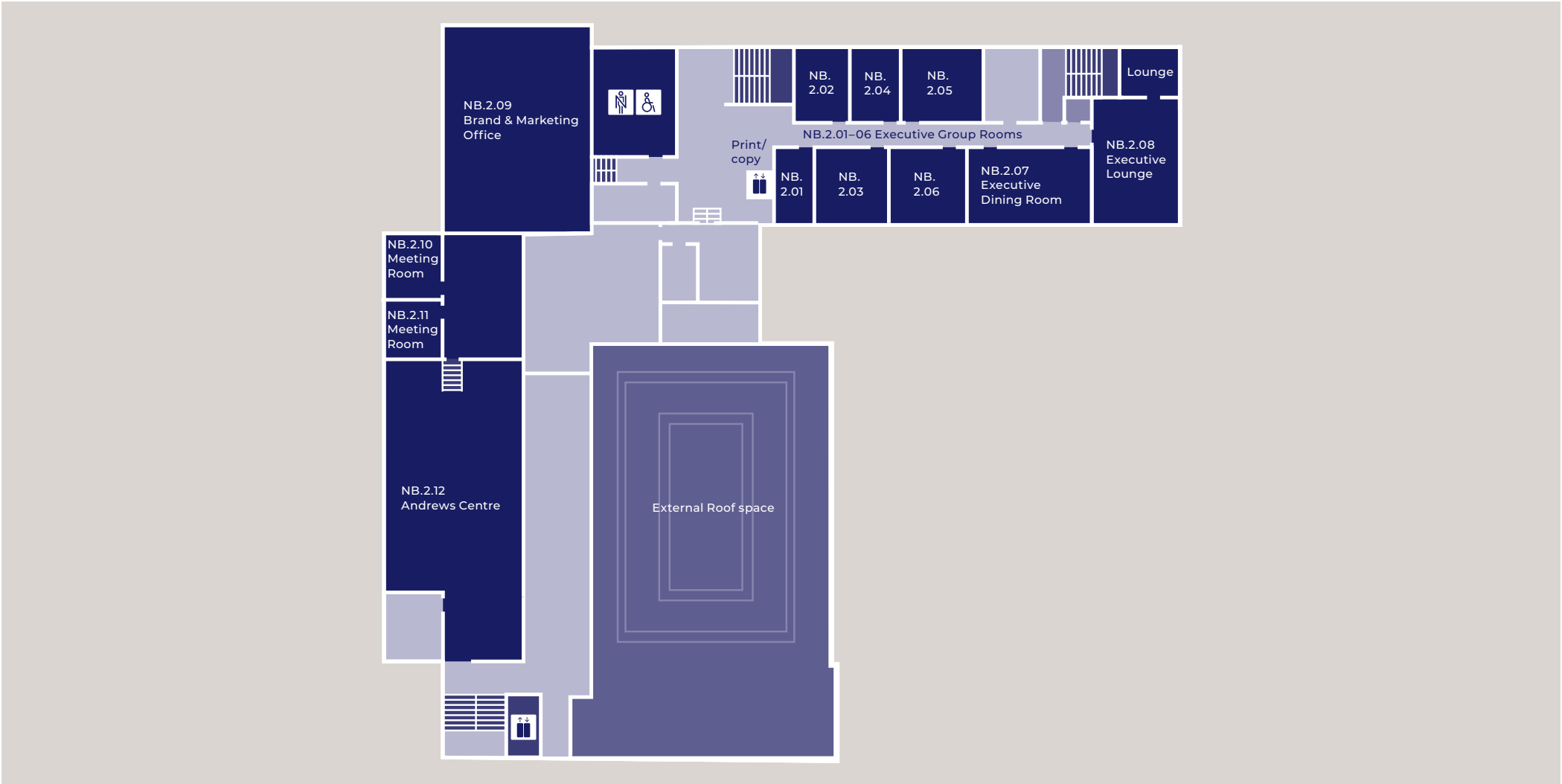

Refer to page 5 for key legend



**London Business School**  
Regent's Park  
London NW1 4SA  
United Kingdom

Tel +44 (0)20 7000 7000  
Fax +44 (0)20 7000 7001  
[london.edu](http://london.edu)

Sussex Place  
North Building  
THIRD FLOOR

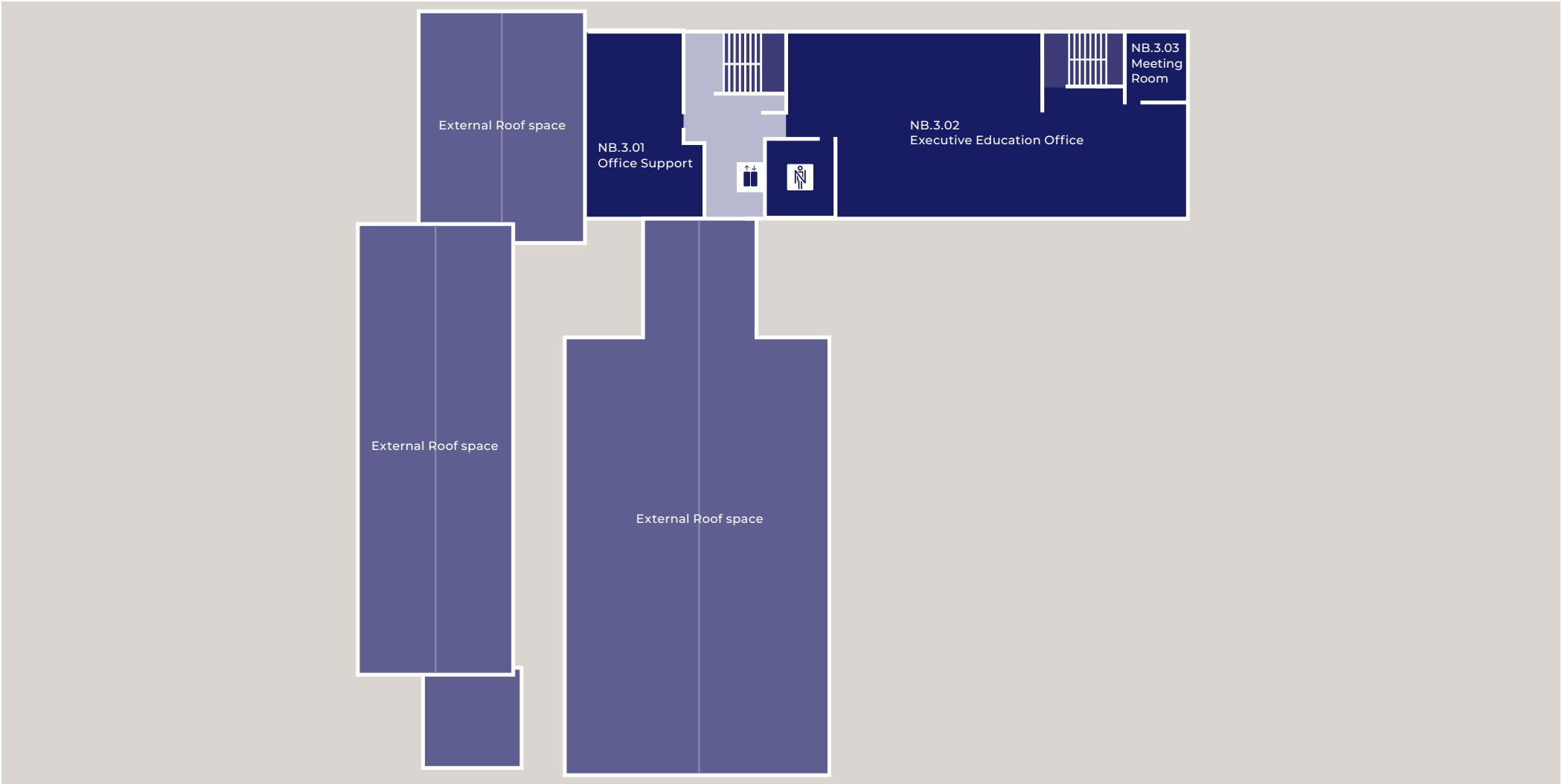

Refer to page 5 for key legend



**London Business School**  
Regent's Park  
London NW1 4SA  
United Kingdom

Tel +44 (0)20 7000 7000  
Fax +44 (0)20 7000 7001  
**[london.edu](http://london.edu)**

# Sammy Ofer Centre

The nearest tube station is Baker Street  
 – use the underpass to cross to the south side of Marylebone Road and walk westbound, the building will be on your left.

From Sussex Place, go straight down Gloucester Place and use the east-side pedestrian crossing at the junction with Marylebone Road.

From Taunton Centre, turn left on Balcombe Street and use the pedestrian crossing at the junction with Marylebone Road.

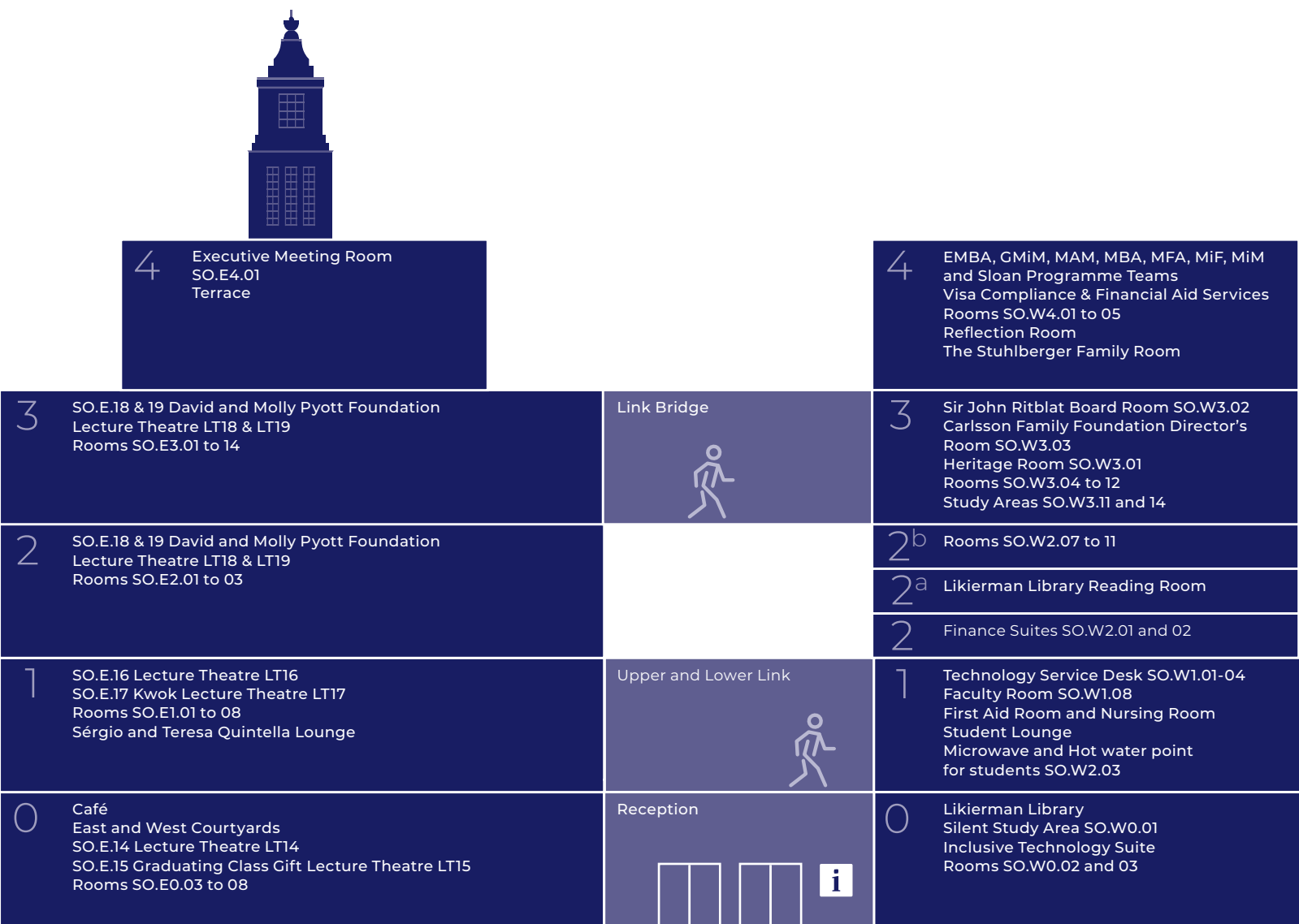

Refer to page 5 for key legend



# Sammy Ofer Centre

## East Wing, Link & West Wing

### GROUND FLOOR



London  
Business  
School

**London Business School**  
Regent's Park  
London NW1 4SA  
United Kingdom

Sammy Ofer Centre  
97-113 Marylebone Road  
London NW1 5PT  
United Kingdom

Tel +44 (0)20 7000 7000  
Fax +44 (0)20 7000 7001  
**london.edu**

Refer to page 5 for key legend



# Sammy Ofer Centre

## East Wing, Link & West Wing

FIRST FLOOR

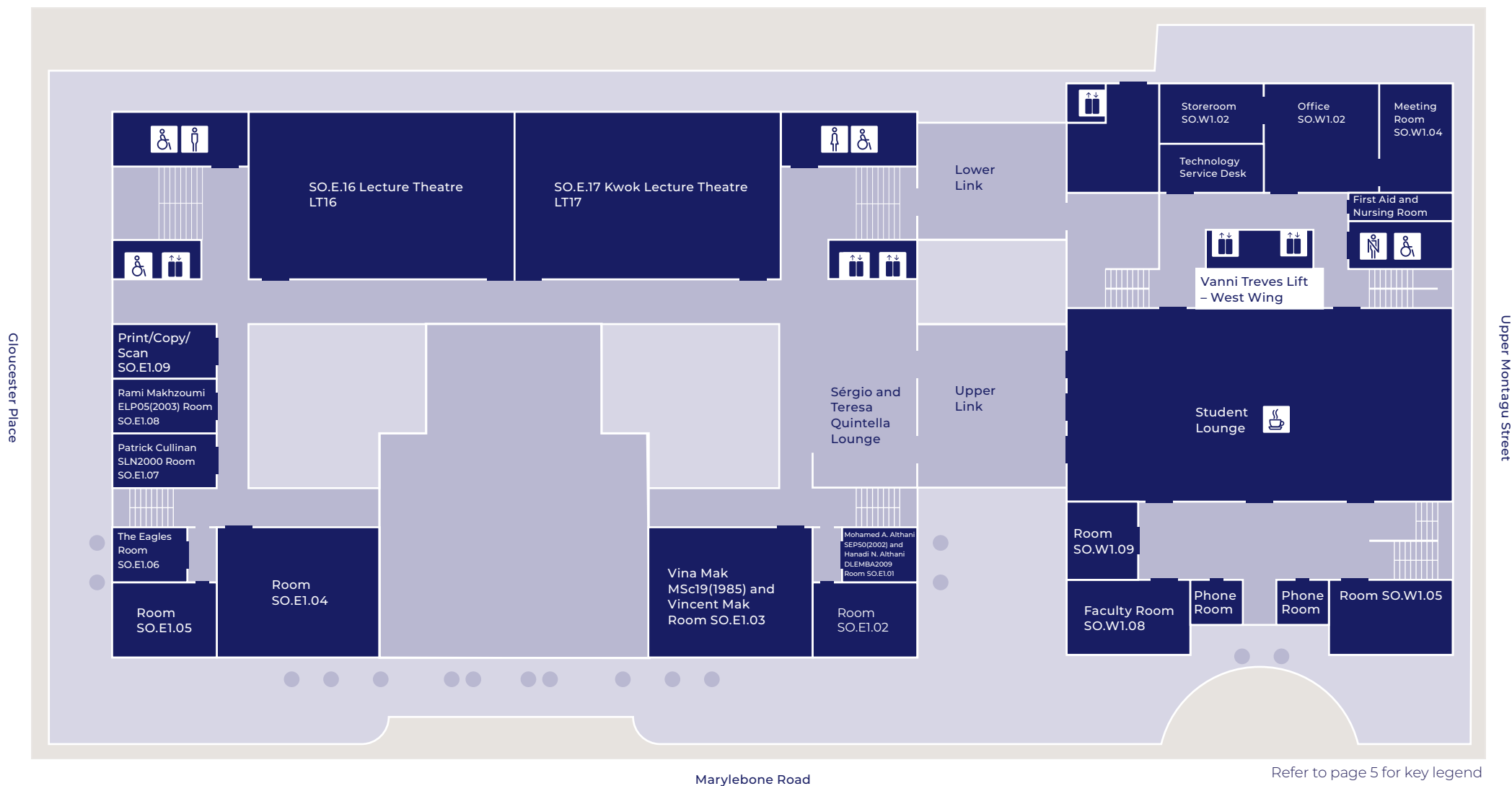

London  
Business  
School

**London Business School**  
Regent's Park  
London NW1 4SA  
United Kingdom

Sammy Ofer Centre  
97-113 Marylebone Road  
London NW1 5PT  
United Kingdom

Tel +44 (0)20 7000 7000  
Fax +44 (0)20 7000 7001  
**[london.edu](http://london.edu)**



# Sammy Ofer Centre

East & West Wings

SECOND FLOOR

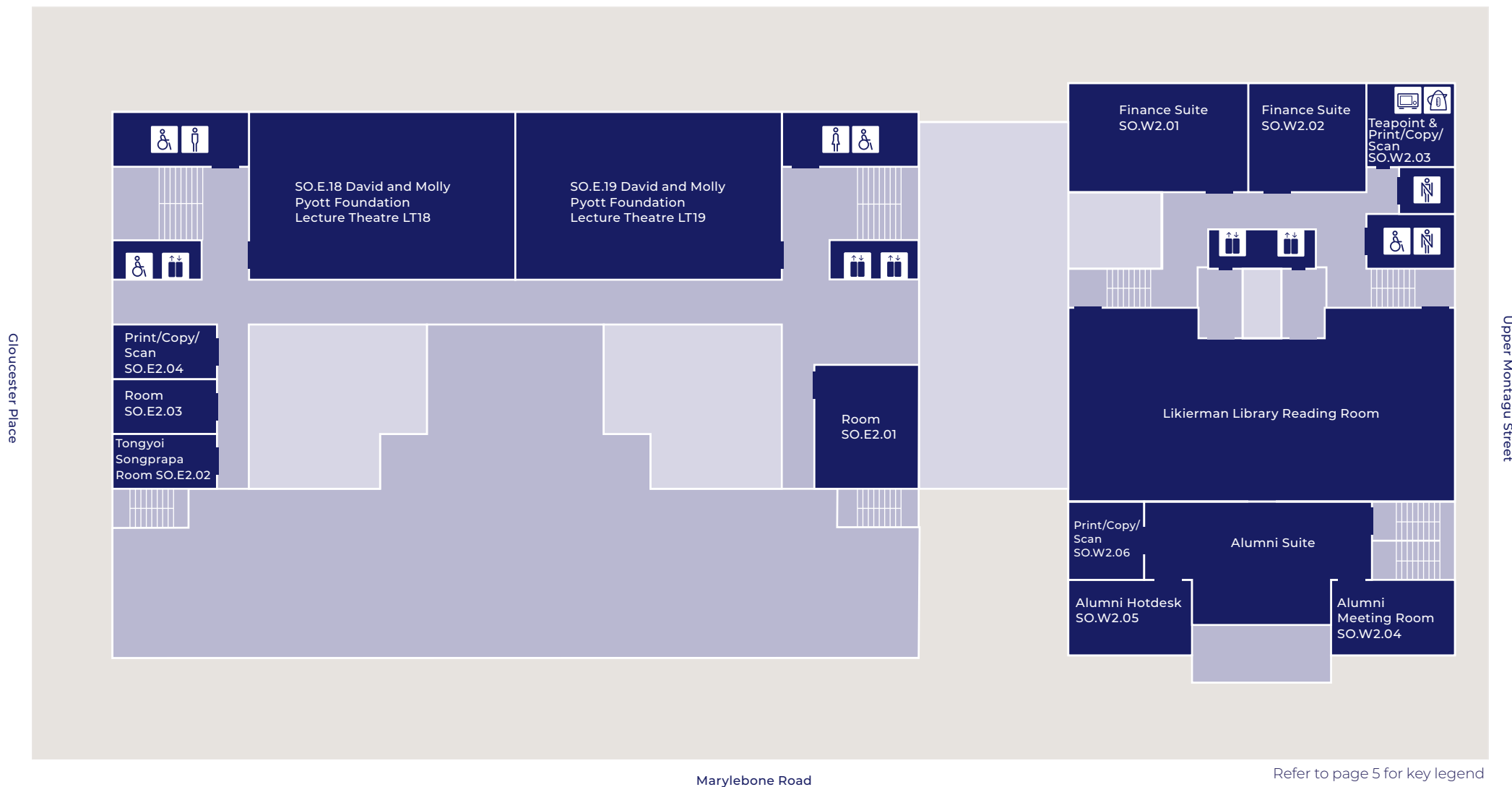

London  
Business  
School

## London Business School

Regent's Park  
London NW1 4SA  
United Kingdom

Sammy Ofer Centre  
97-113 Marylebone Road  
London NW1 5PT  
United Kingdom

Tel +44 (0)20 7000 7000  
Fax +44 (0)20 7000 7001

[london.edu](http://london.edu)





# Sammy Ofer Centre West Wing

## SECOND FLOOR MEZZANINE

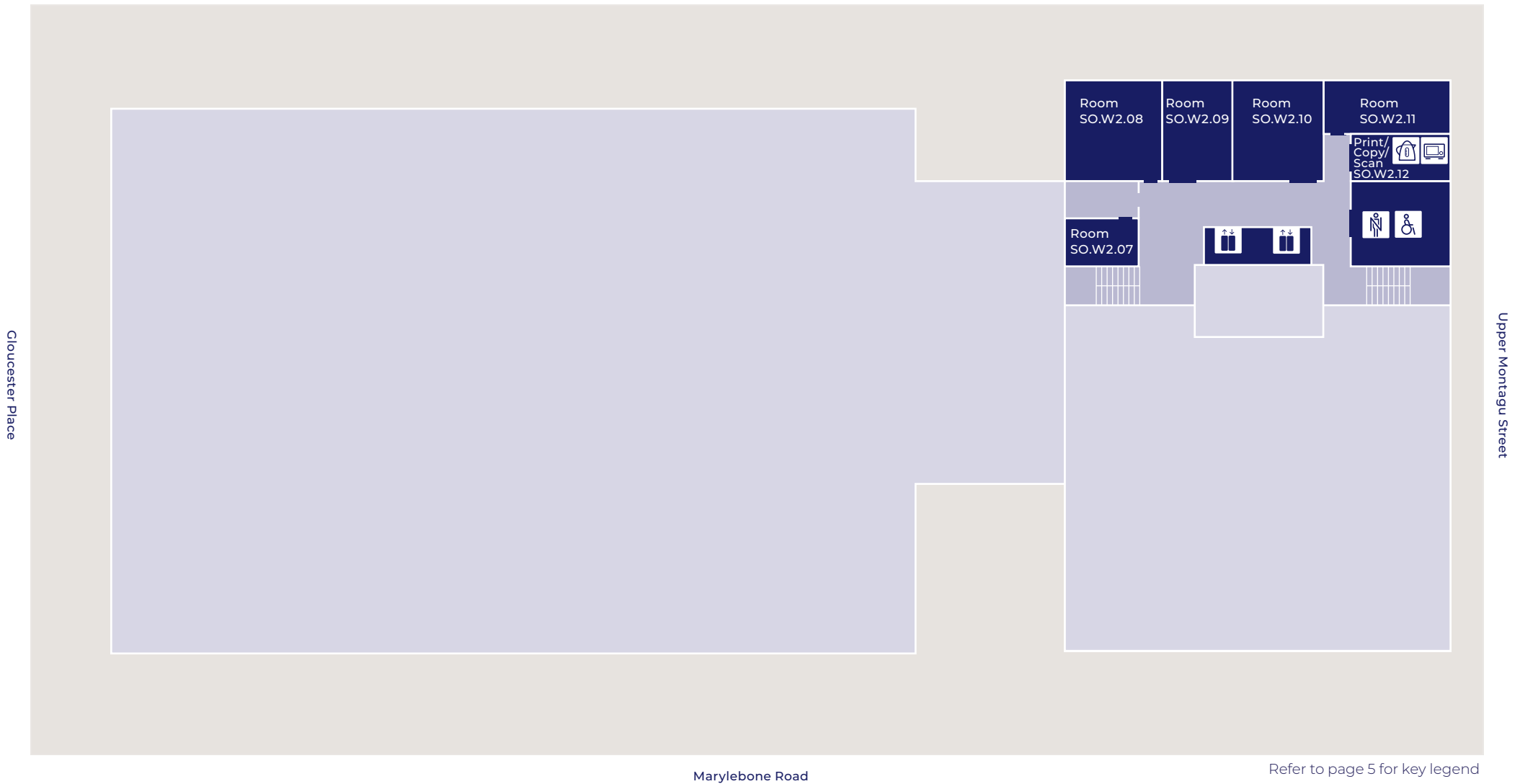

London  
Business  
School

**London Business School**  
Regent's Park  
London NW1 4SA  
United Kingdom

Sammy Ofer Centre  
97-113 Marylebone Road  
London NW1 5PT  
United Kingdom

Tel +44 (0)20 7000 7000  
Fax +44 (0)20 7000 7001  
**[london.edu](http://london.edu)**



# Sammy Ofer Centre

## East Wing, Link & West Wing

### THIRD FLOOR

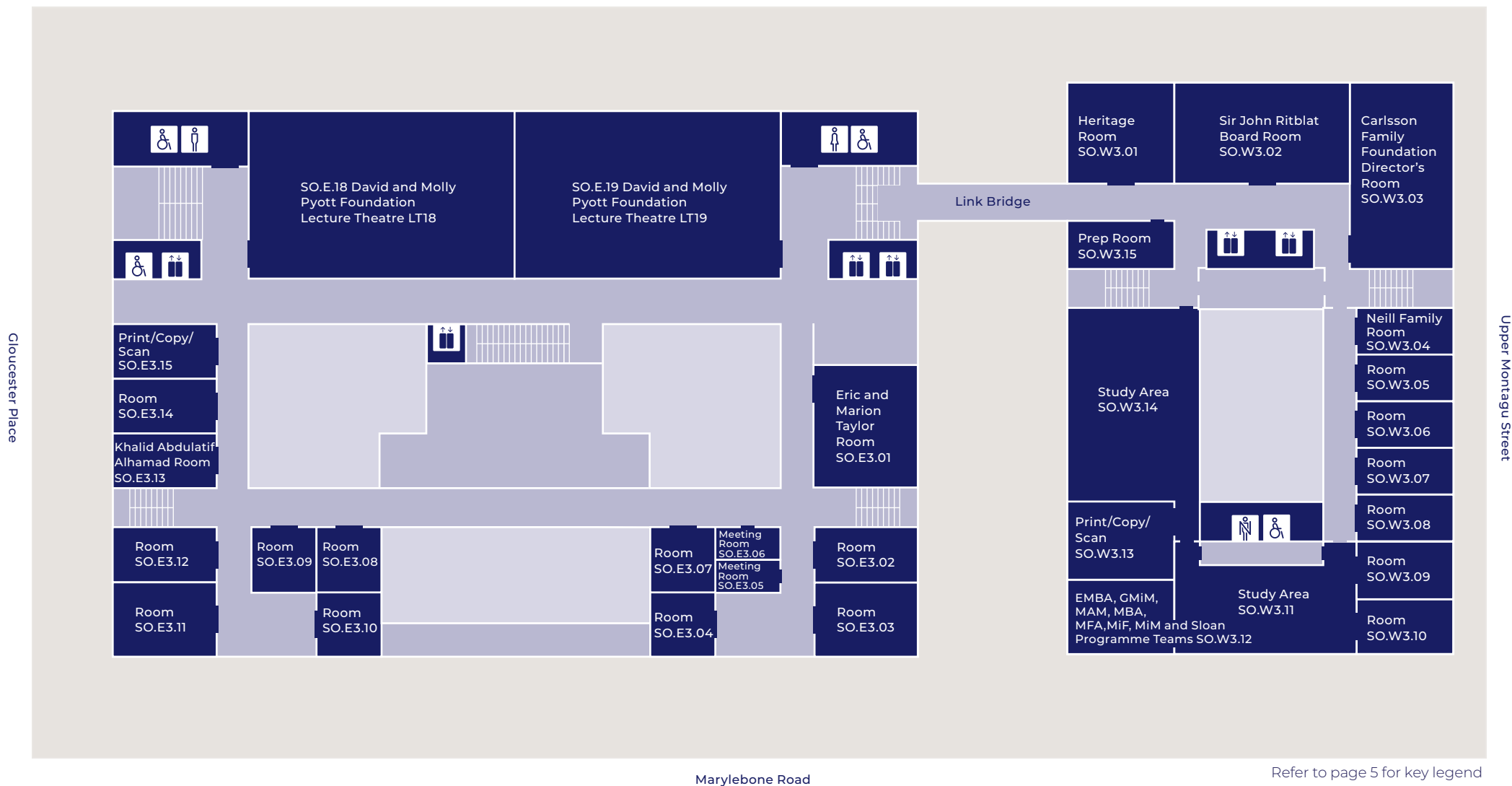

London  
Business  
School

**London Business School**  
Regent's Park  
London NW1 4SA  
United Kingdom

Sammy Ofer Centre  
97-113 Marylebone Road  
London NW1 5PT  
United Kingdom

Tel +44 (0)20 7000 7000  
Fax +44 (0)20 7000 7001  
**[london.edu](http://london.edu)**



# Sammy Ofer Centre

East & West Wings

FOURTH FLOOR

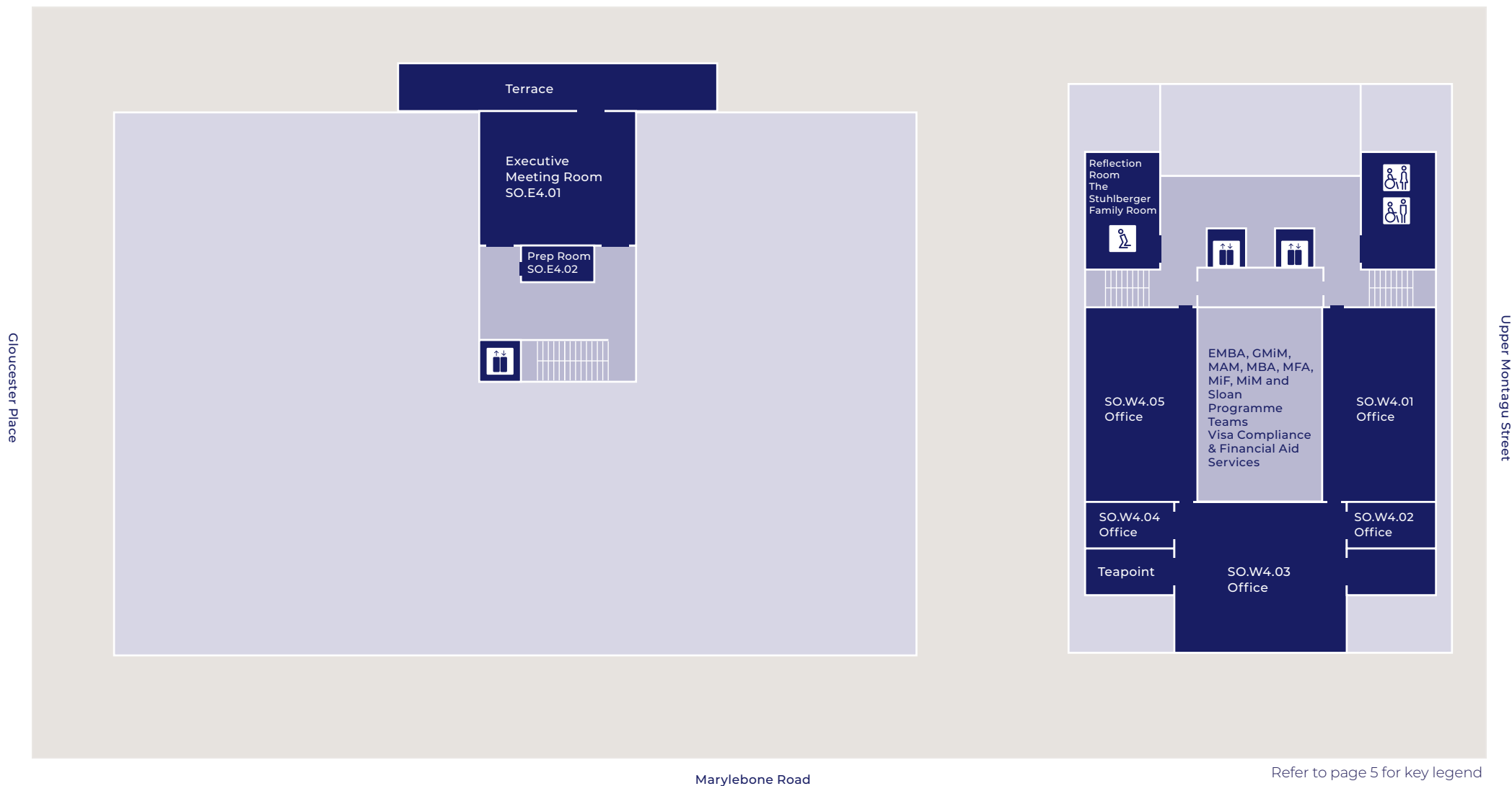

London  
Business  
School

## London Business School

Regent's Park  
London NW1 4SA  
United Kingdom

Sammy Ofer Centre  
97-113 Marylebone Road  
London NW1 5PT  
United Kingdom

Tel +44 (0)20 7000 7000  
Fax +44 (0)20 7000 7001

[london.edu](http://london.edu)

Refer to page 5 for key legend